

A417 Missing Link
TR010056

2.6c Structures Engineering
Drawings and Sections

Planning Act 2008

APFP Regulation 5(2)(0)
Infrastructure Planning (Applications: Prescribed Forms and
Procedure) Regulations 2009

Volume 2

March 2022

Infrastructure Planning

Planning Act 2008

**The Infrastructure Planning
(Applications: Prescribed Forms
and Procedure) Regulations 2009**

A417 Missing Link

Development Consent Order 202[x]

2.6c Structures Engineering Drawings and Sections

Regulation Number:	5(2)(0)
Planning Inspectorate Scheme Reference	TR010056
Application Document Reference	2.6c
Author:	A417 Missing Link

Version	Date	Status of Version
C01	March 2022	Deadline 6

Contents

1. Structures Engineering Drawings and Sections - Cotswold Way Crossing
2. Structures Engineering Drawings and Sections - Cowley Overbridge
3. Structures Engineering Drawings and Sections - Crickley Hill Bat Underpass
4. Structures Engineering Drawings and Sections - Gloucestershire Way Crossing
5. Structures Engineering Drawings and Sections - Grove Farm Underpass
6. Structures Engineering Drawings and Sections - Shab Hill Junction Underbridge
7. Structures Engineering Drawings and Sections - Stockwell Overbridge

DO NOT SCALE

100
0 10
Millimetres

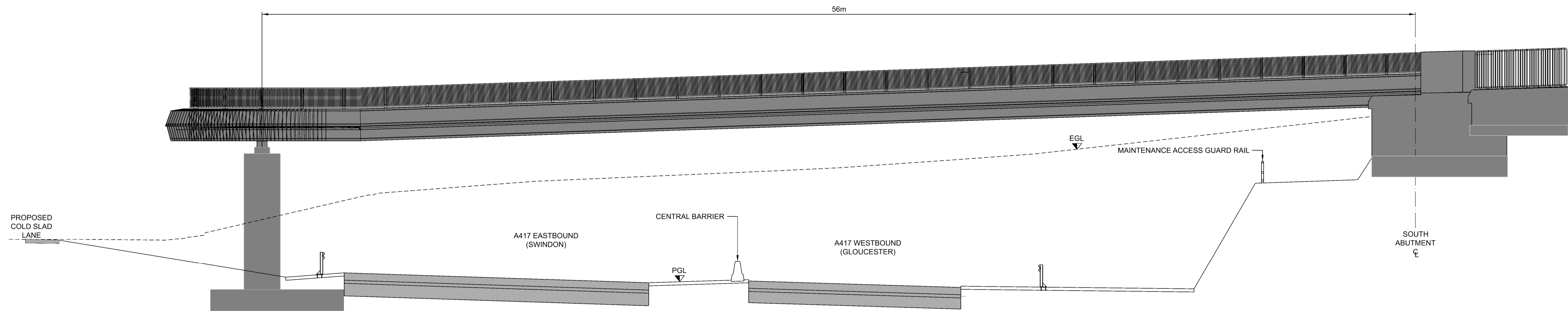

PROFILE
SCALE 1:100

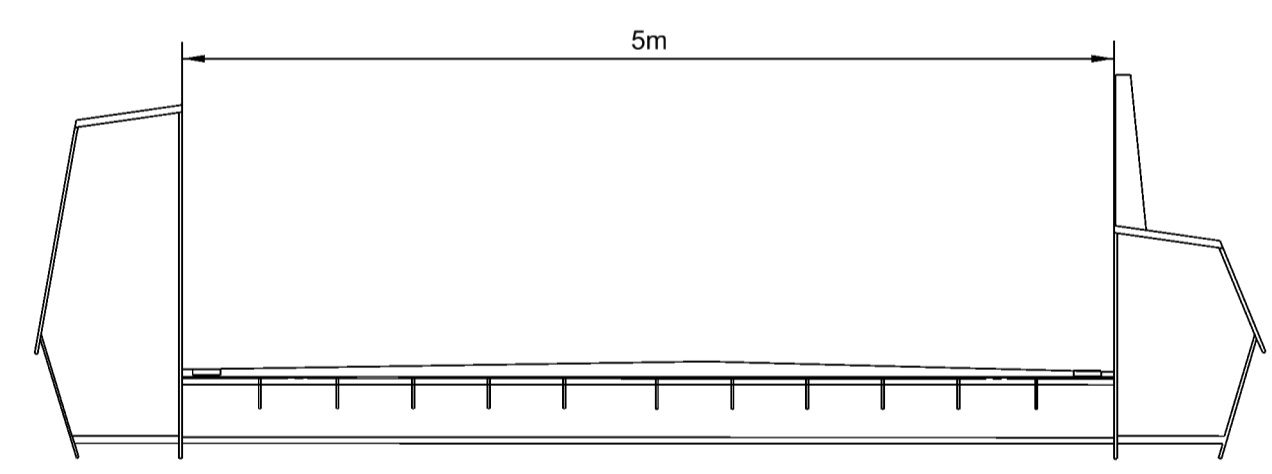

SECTION A-A
SCALE 1:50

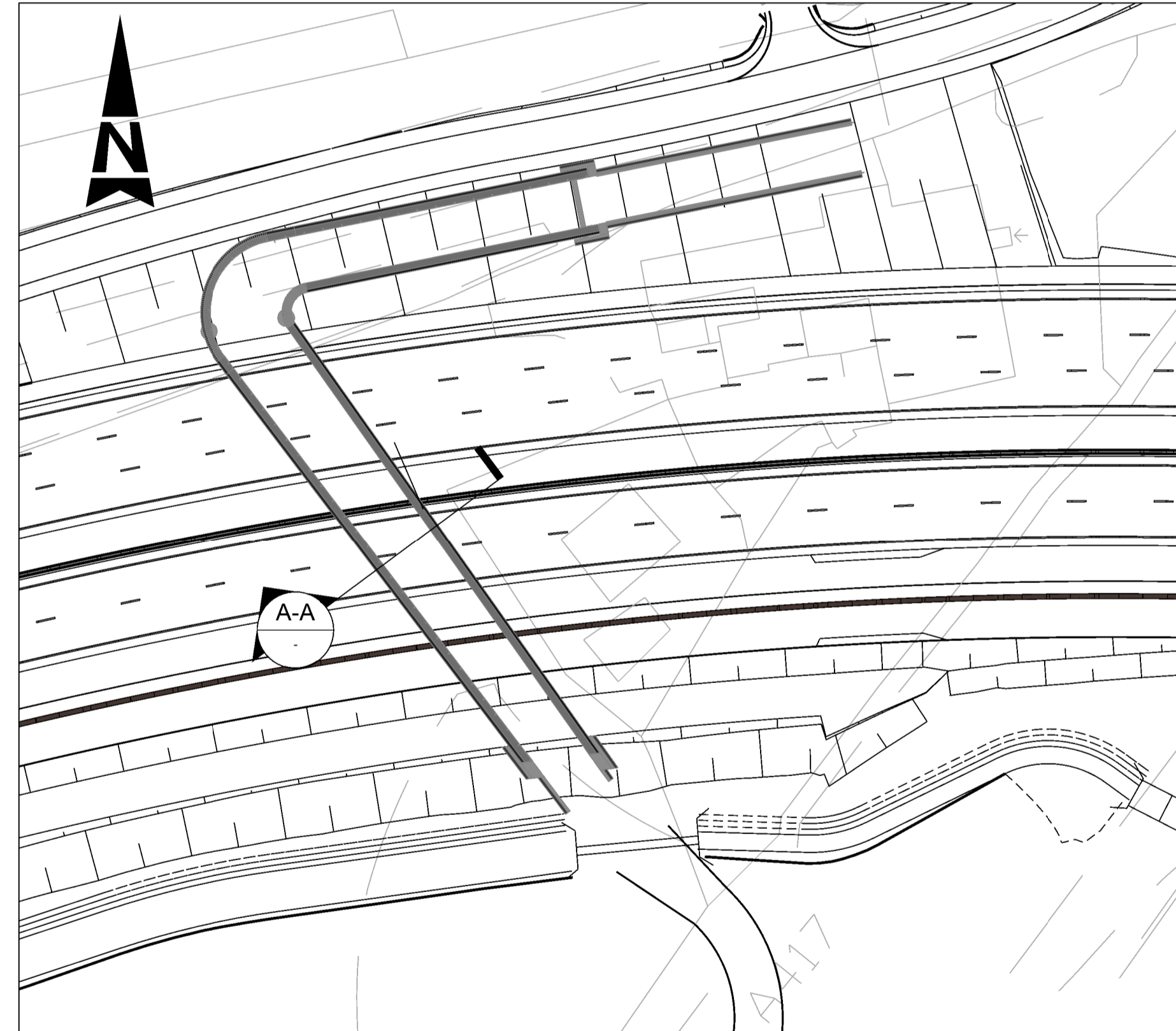

PLAN
SCALE 1:500

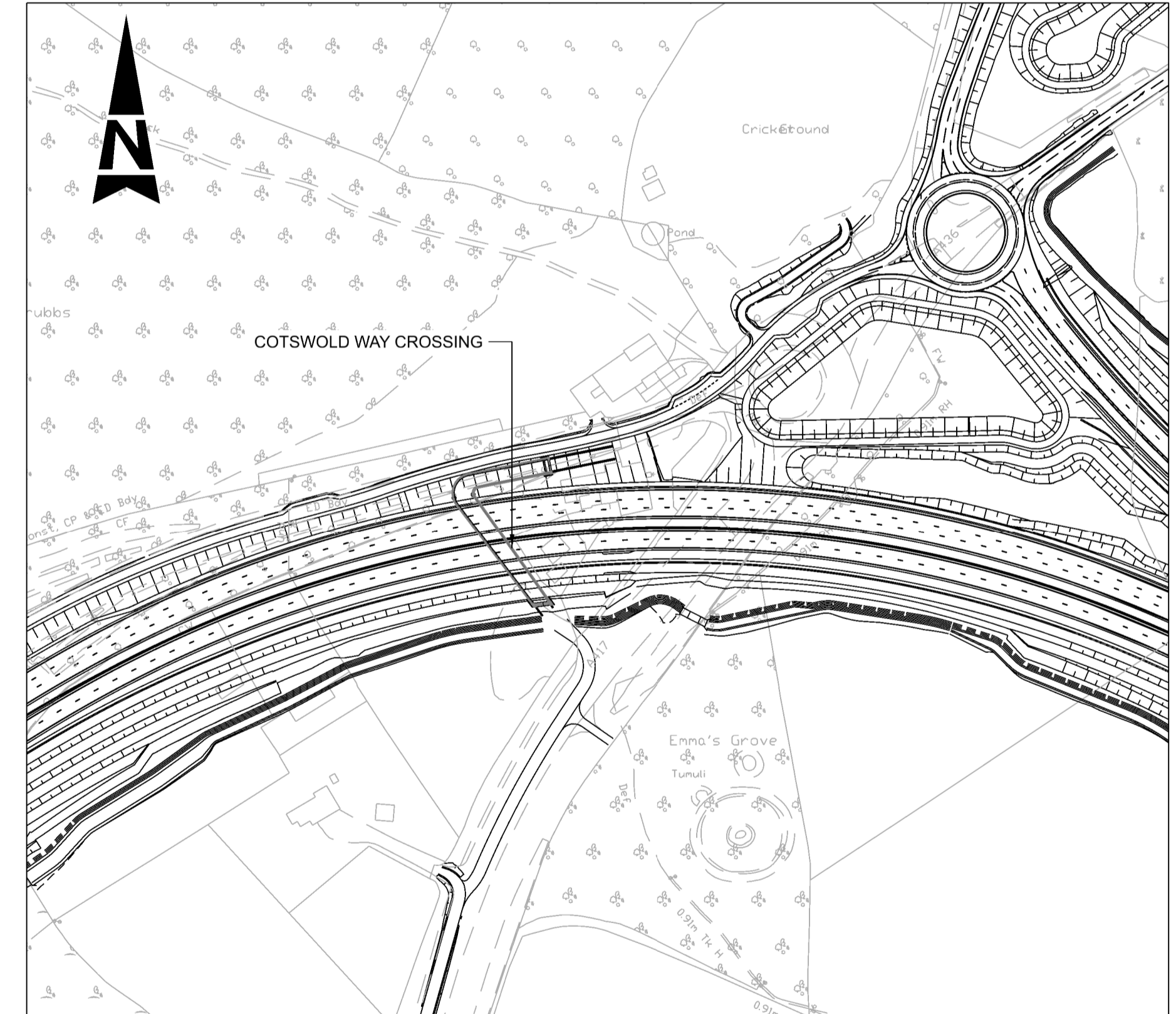

LOCATION PLAN
SCALE 1:2000

This map is reproduced from Ordnance Survey material with the permission of Ordnance Survey on behalf of the controller of Her Majesty's Stationery Office. © Crown Copyright. Unauthorised reproduction infringes Crown copyright and may lead to prosecution or civil proceedings. CLIENT NAME: Highways England LICENCE NUMBER: 100030649 (2019)

- NOTES**
- THE DESIGN AND LOCATION OF THE STRUCTURE IS SHOWN HERE FOR ILLUSTRATIVE PURPOSES ONLY AND WILL BE SUBJECT TO DETAILED DESIGN DEVELOPMENT IN ACCORDANCE WITH THE PROVISIONS OF THE DEVELOPMENT CONSENT ORDER.
 - FOR ENVIRONMENTAL DETAILS REFER TO THE ENVIRONMENTAL MASTER PLAN AND ASSOCIATED DRAWINGS/DOCUMENTS.
 - FOR PUBLIC ACCESS DETAILS REFER TO THE RIGHTS OF WAY AND ACCESS PLANS
 - DETAILED DESIGN OF ALL STRUCTURES IS TO COMPLY WITH ALL RELEVANT PROVISIONS OF THE ENVIRONMENTAL MANAGEMENT PLAN, INCLUDING (WHERE APPLICABLE) COMMITMENT GP8, BD41, BD49, BD54, BD55, SD56, L5, L6, L7, L8, L9, L10, L11, L12, L21, L25
 - THE DETAILED DESIGN OF ALL STRUCTURES IS TO BE IN ACCORDANCE WITH THE DESIGN PRINCIPLES SET OUT IN THE DESIGN SUMMARY REPORT TO ENSURE THAT THE DESIGN, FORM AND APPEARANCE OF ALL BRIDGE STRUCTURES WILL RESPOND TO THE NATURAL AND BUILT CHARACTER OF THE COTSWOLDS AONS
 - EGL = EXISTING GROUND LEVEL, PGL = PROPOSED GROUND LEVEL



Rev.	Date	Description	By	Chk'd	App'd	Auth'd
C01	22/03/22	DEADLINE 6 ISSUE TO PINS	EM	DA	JP	JP

Suitability	Drawing Status
A4	STAGE COMPLETED
ARUP	
highways england	

Project Title						A417 MISSING LINK					
Drawing Title						STRUCTURES ENGINEERING DRAWINGS AND SECTIONS COTSWOLD WAY CROSSING APPLICATION NUMBER TR010056					
Scale	By	Checked	Approved	Authorised		As Shown	EM	DA	JP	JP	
Original Size	Date	Date	Date	Date		A1	22/03/22	22/03/22	22/03/22	22/03/22	
Drawing Number	HE PIN	Originator	Volume	Revision		HE551505 -	ARP	-	LSI		C01
X_ML_40065_Z	-DR - ZL	-000001									
Location	Type	Role	Number								

DO NOT SCALE

100
0 10
Millimetres

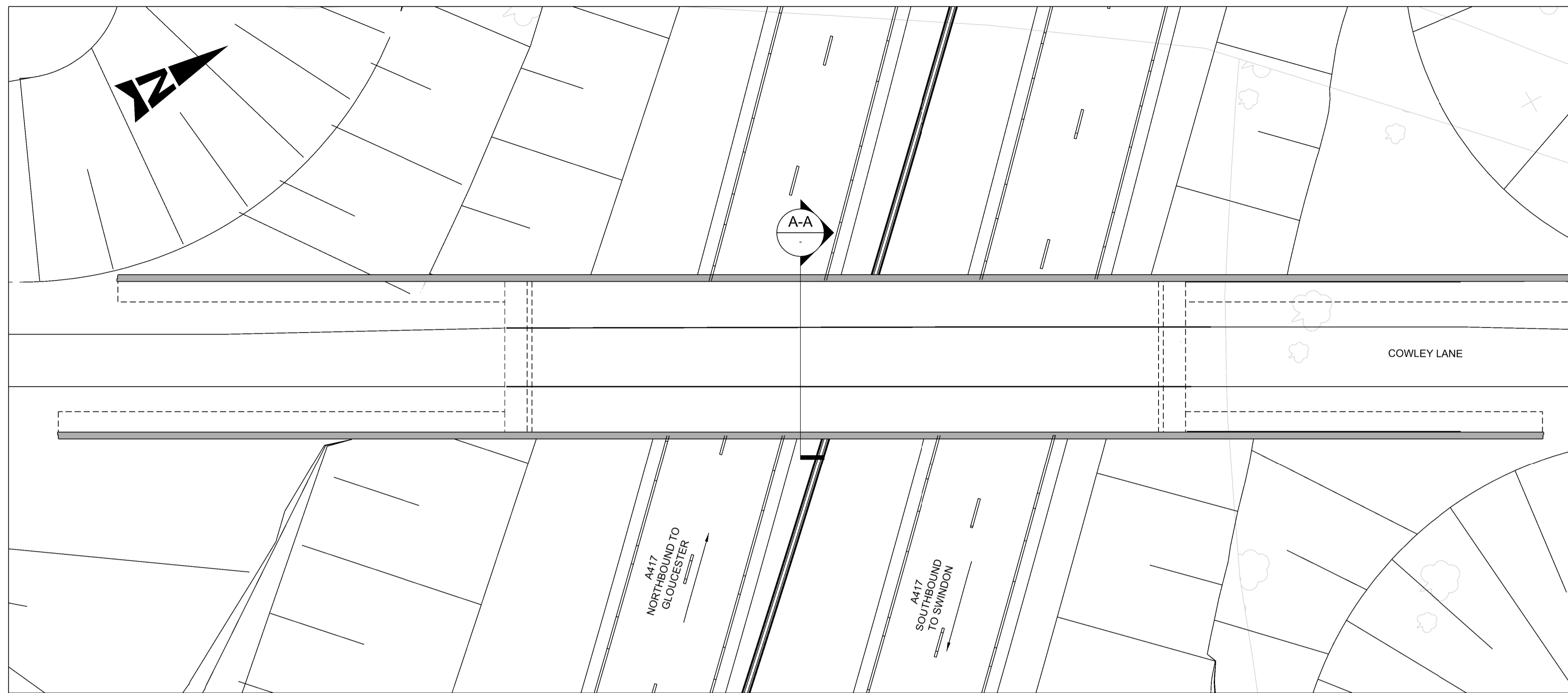

PLAN
SCALE 1:200

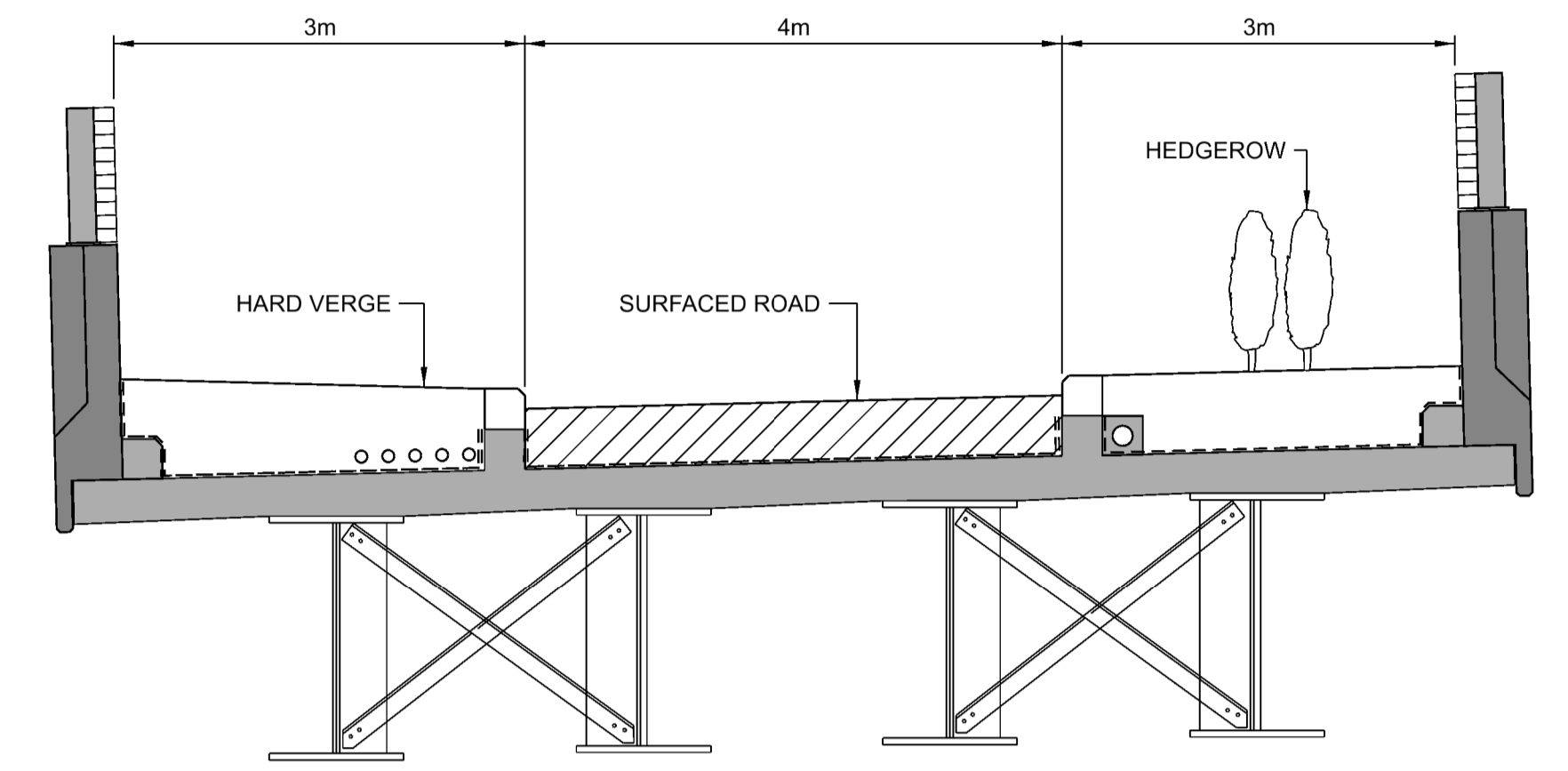

SECTION A-A
SCALE 1:50

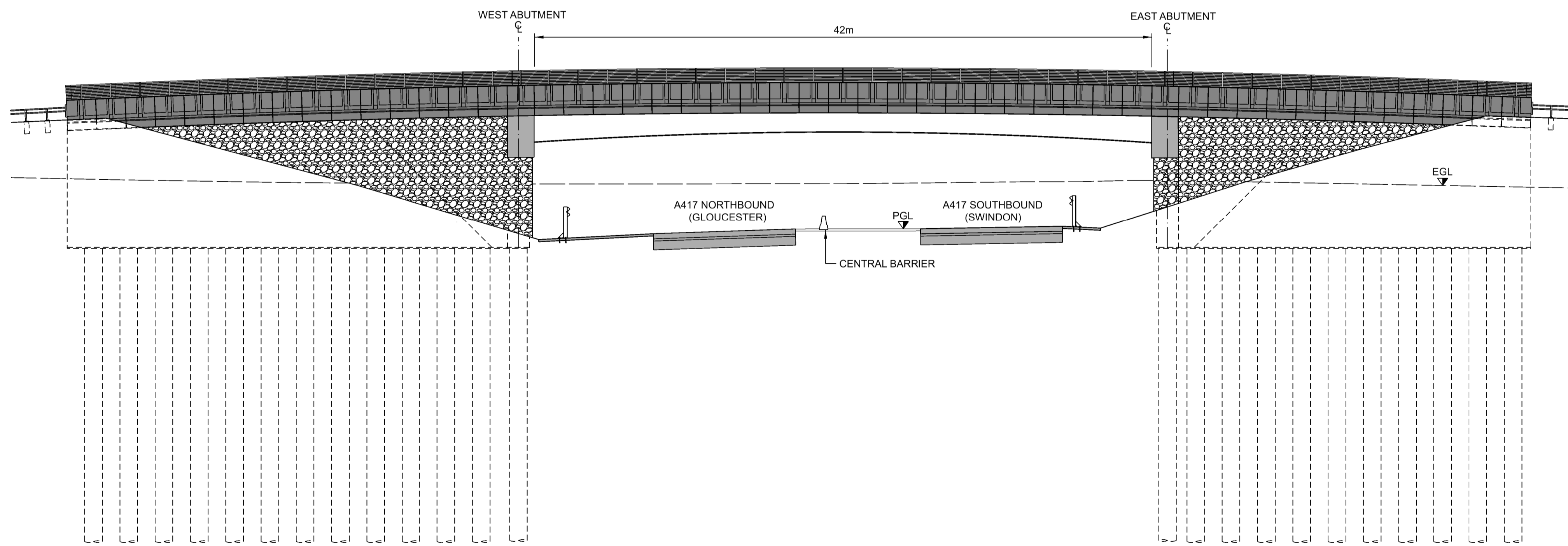

PROFILE
SCALE 1:200

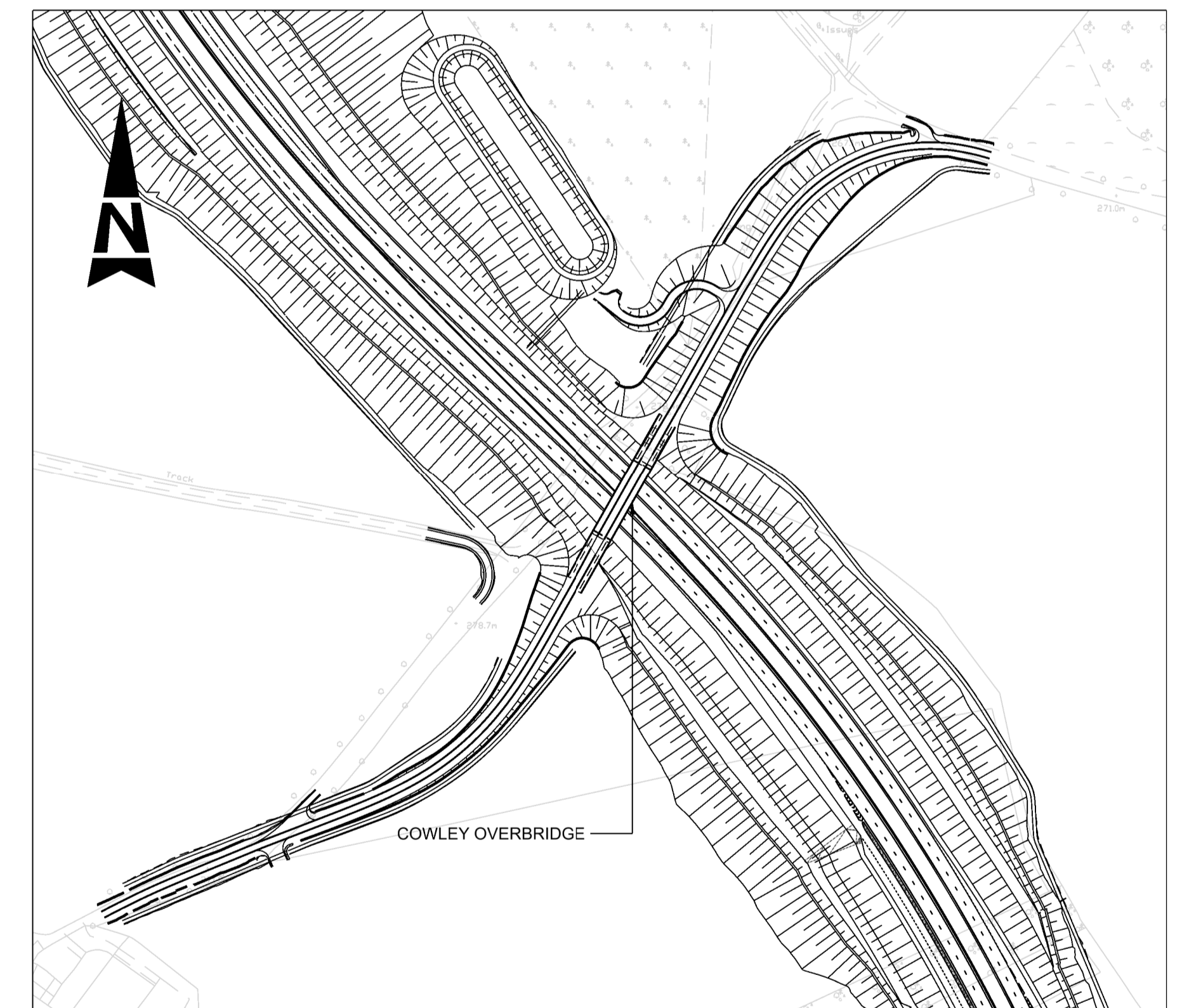

LOCATION PLAN
SCALE 1:2500

NOTES

- THE DESIGN AND LOCATION OF THE STRUCTURE IS SHOWN HERE FOR ILLUSTRATIVE PURPOSES ONLY AND WILL BE SUBJECT TO DETAILED DESIGN DEVELOPMENT IN ACCORDANCE WITH THE PROVISIONS OF THE DEVELOPMENT CONSENT ORDER.
- FOR ENVIRONMENTAL DETAILS REFER TO THE ENVIRONMENTAL MASTER PLAN AND ASSOCIATED DRAWINGS/DOCUMENTS.
- FOR PUBLIC ACCESS DETAILS REFER TO THE RIGHTS OF WAY AND ACCESS PLANS.
- DETAILED DESIGN OF ALL STRUCTURES IS TO COMPLY WITH ALL RELEVANT PROVISIONS OF THE ENVIRONMENTAL MANAGEMENT PLAN, INCLUDING (WHERE APPLICABLE) COMMITMENT GPR, BD41, BD49, BD54, BD55, SD56, L5, L6, L7, L8, L9, L10, L11, L12, L21, L25.
- THE DETAILED DESIGN OF ALL STRUCTURES IS TO BE IN ACCORDANCE WITH THE DESIGN PRINCIPLES SET OUT IN THE DESIGN SUMMARY REPORT TO ENSURE THAT THE DESIGN, FORM AND APPEARANCE OF ALL BRIDGE STRUCTURES WILL RESPOND TO THE NATURAL AND BUILT CHARACTER OF THE COTSWOLDS AONS.
- EGL = EXISTING GROUND LEVEL, PGL = PROPOSED GROUND LEVEL.

KEYPLAN



Rev.	Date	Description	By	Chk'd	App'd	Auth'd
C01	22/03/22	DEADLINE 6 ISSUE TO PINS	EM	DA	JP	JP

Suitability	Drawing Status
A4	STAGE COMPLETED

ARUP

highways
england

Project Title	A417 MISSING LINK				
---------------	-------------------	--	--	--	--

Drawing Title STRUCTURES ENGINEERING DRAWINGS AND SECTIONS COWLEY OVERBRIDGE APPLICATION NUMBER TR010056					
Scale	By	Checked	Approved	Authorised	
As Shown	EM	DA	JP	JP	
Original Size	Date	Date	Date	Date	
A1	22/03/22	22/03/22	22/03/22	22/03/22	
Drawing Number	HE PIN	Originator	Volume	Revision	
HE551505 - ARP	HE551505 - ARP	LSI		C01	
X_ML_39185_Z	-DR - ZL - 000001				
Location	Type	Role	Number		

DO NOT SCALE

100
0 10
Millimetres

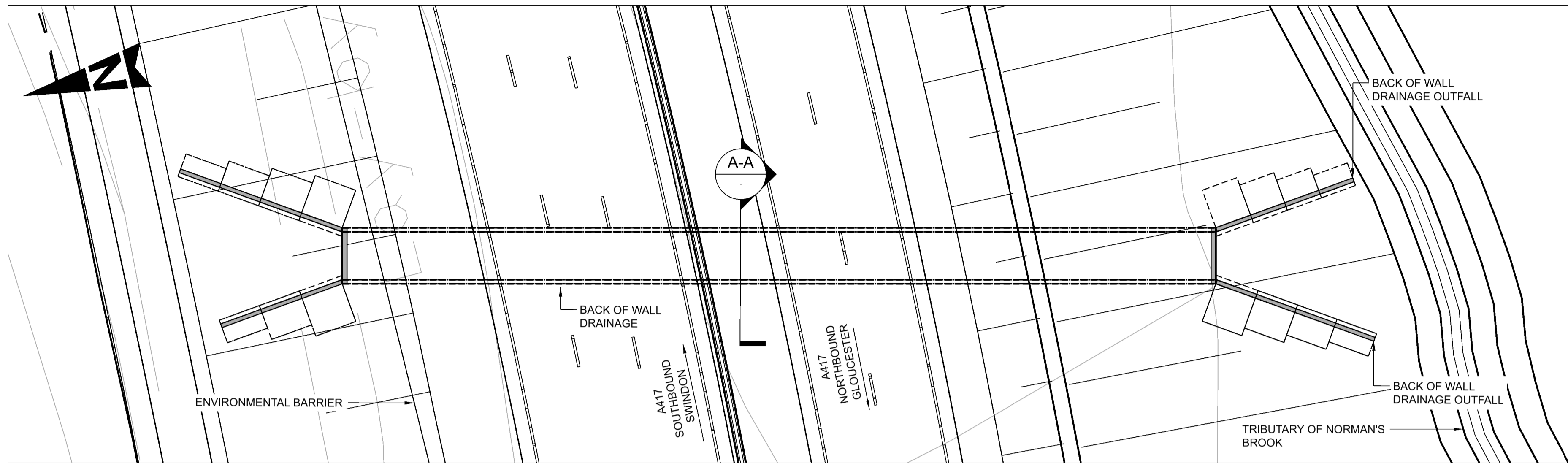

PLAN
SCALE 1:200

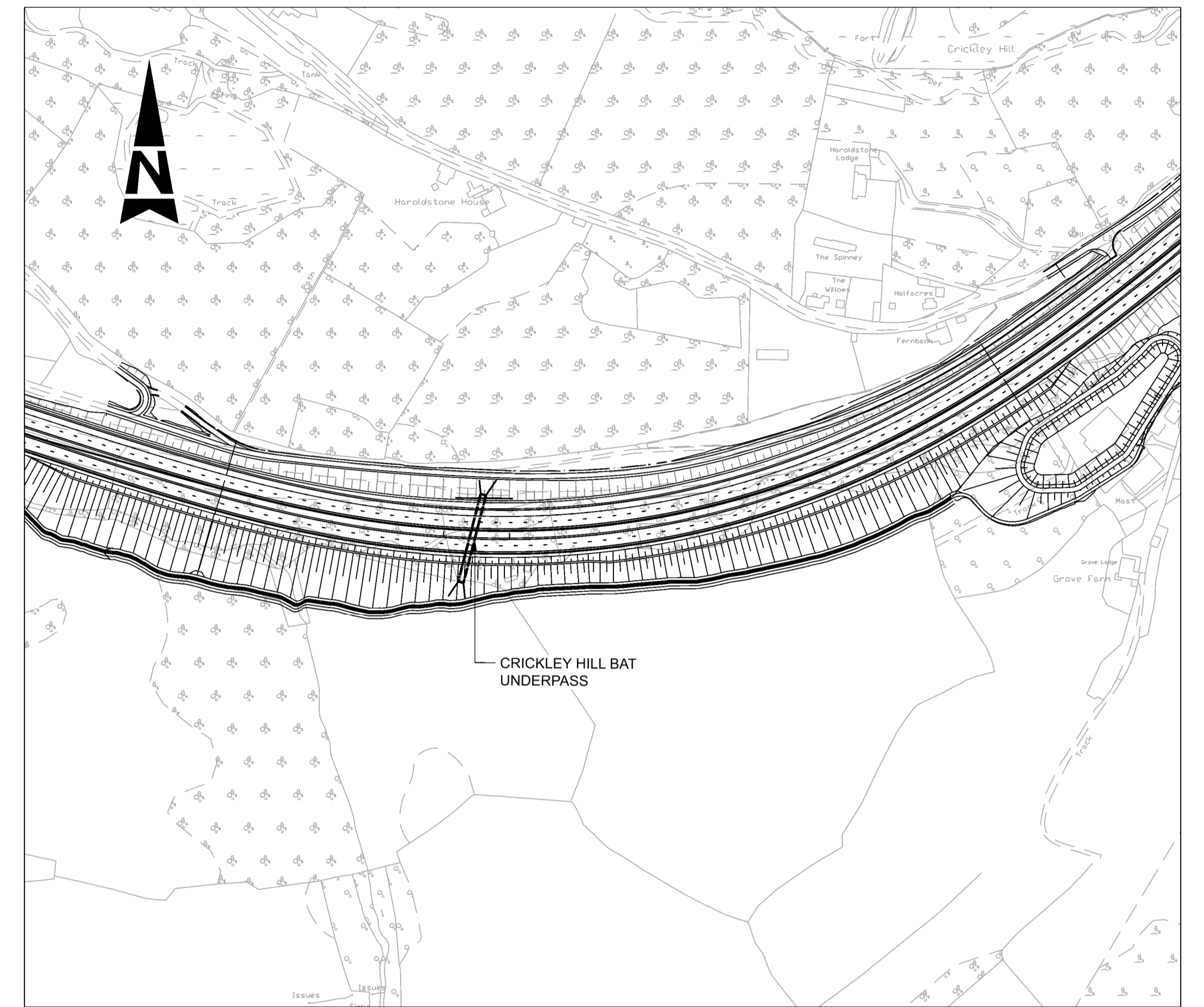

LOCATION PLAN
SCALE 1:2500

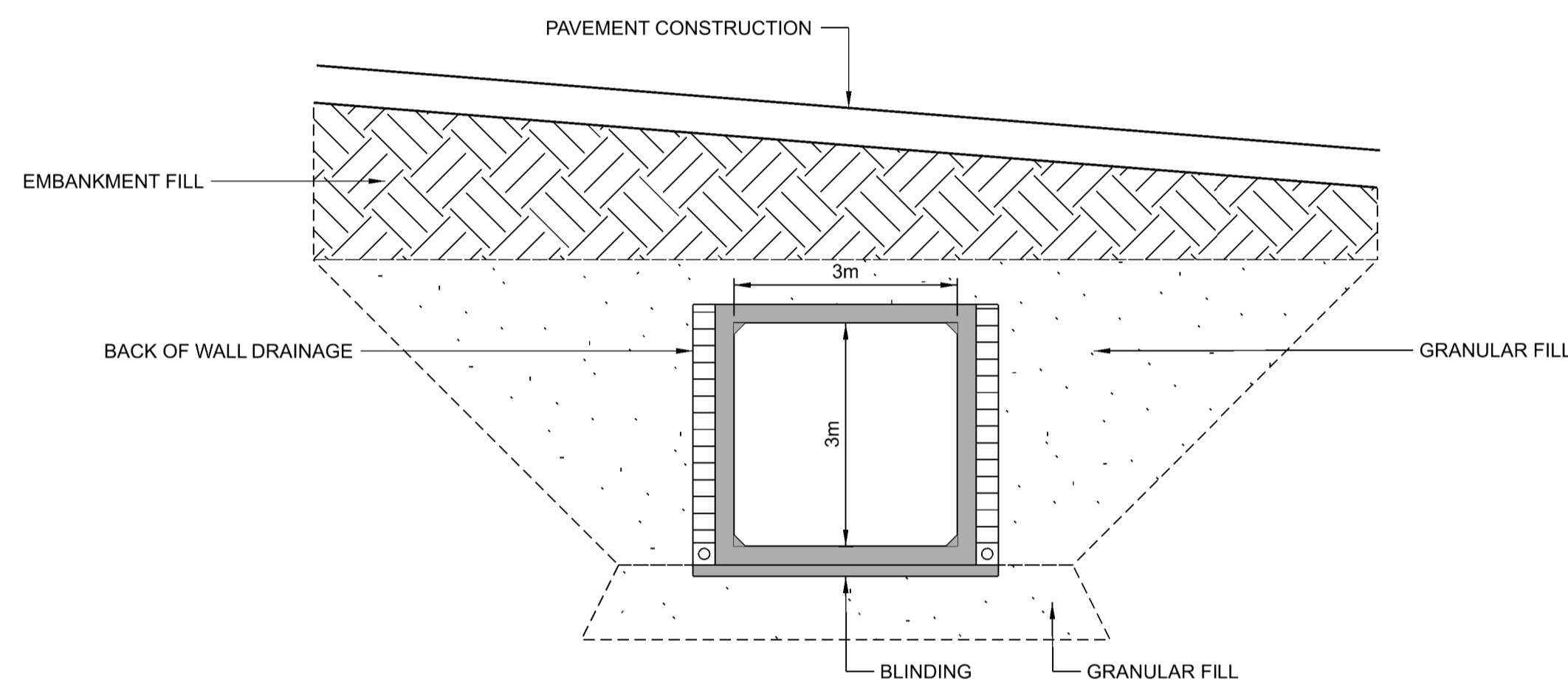

SECTION A-A
SCALE 1:75

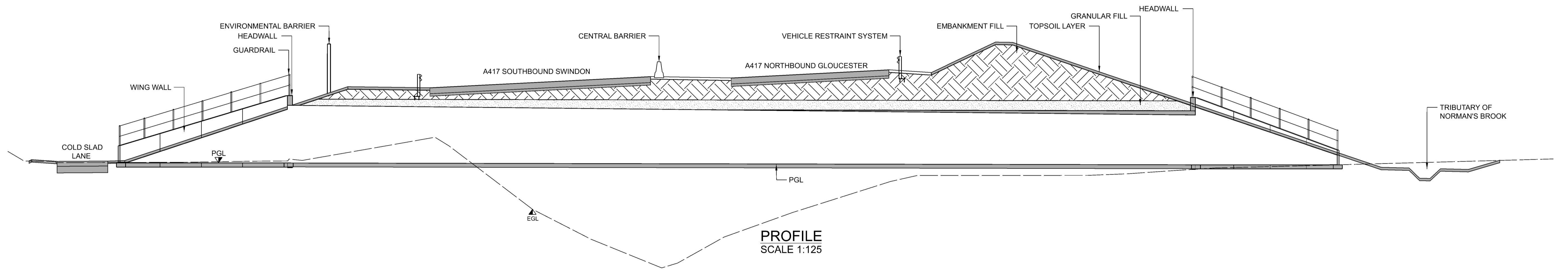

PROFILE
SCALE 1:125

- NOTES**
1. THE DESIGN AND LOCATION OF THE STRUCTURE IS SHOWN HERE FOR ILLUSTRATIVE PURPOSES ONLY AND WILL BE SUBJECT TO DETAILED DESIGN DEVELOPMENT IN ACCORDANCE WITH THE PROVISIONS OF THE DEVELOPMENT CONSENT ORDER.
 2. FOR ENVIRONMENTAL DETAILS REFER TO THE ENVIRONMENTAL MASTER PLAN AND ASSOCIATED DRAWINGS/DOCUMENTS.
 3. FOR PUBLIC ACCESS DETAILS REFER TO THE RIGHTS OF WAY AND ACCESS PLANS
 4. DETAILED DESIGN OF ALL STRUCTURES IS TO COMPLY WITH ALL RELEVANT PROVISIONS OF THE ENVIRONMENTAL MANAGEMENT PLAN, INCLUDING (WHERE APPLICABLE) COMMITMENT GPs, BD41, BD49, BD54, BD55, SD56, L5, L6, L7, L8, L9, L10, L11, L12, L21, L25
 5. THE DETAILED DESIGN OF ALL STRUCTURES IS TO BE IN ACCORDANCE WITH THE DESIGN PRINCIPLES SET OUT IN THE DESIGN SUMMARY REPORT TO ENSURE THAT THE DESIGN, FORM AND APPEARANCE OF ALL BRIDGE STRUCTURES WILL RESPOND TO THE NATURAL AND BUILT CHARACTER OF THE COTSWOLDS AONS
 6. EGL = EXISTING GROUND LEVEL, PGL = PROPOSED GROUND LEVEL



Rev.	Date	Description	By	Chk'd	App'd	Auth'd
C01	22/03/22	DEADLINE 6 ISSUE TO PINS	EM	DA	JP	JP

Suitability: **A4** | Drawing Status: **STAGE COMPLETED**

ARUP

highways
england

Project Title: A417 MISSING LINK					
Drawing Title: STRUCTURES ENGINEERING DRAWINGS AND SECTIONS CRICKLEY HILL BAT UNDERPASS APPLICATION NUMBER TR010056					
Scale: As Shown	By: EM	Checked: DA	Approved: JP	Authorised: JP	
Original Size: A1	Date: 22/03/22	Date: 22/03/22	Date: 22/03/22	Date: 22/03/22	
Drawing Number: HE PIN HE551505 - X_ML_40052_Z	Originator: ARP	Volume: LSI	Revision: C01		
Location:	Type: -DR - ZL	Role: -000001	Number:		

DO NOT SCALE

100
0 10
Millimetres

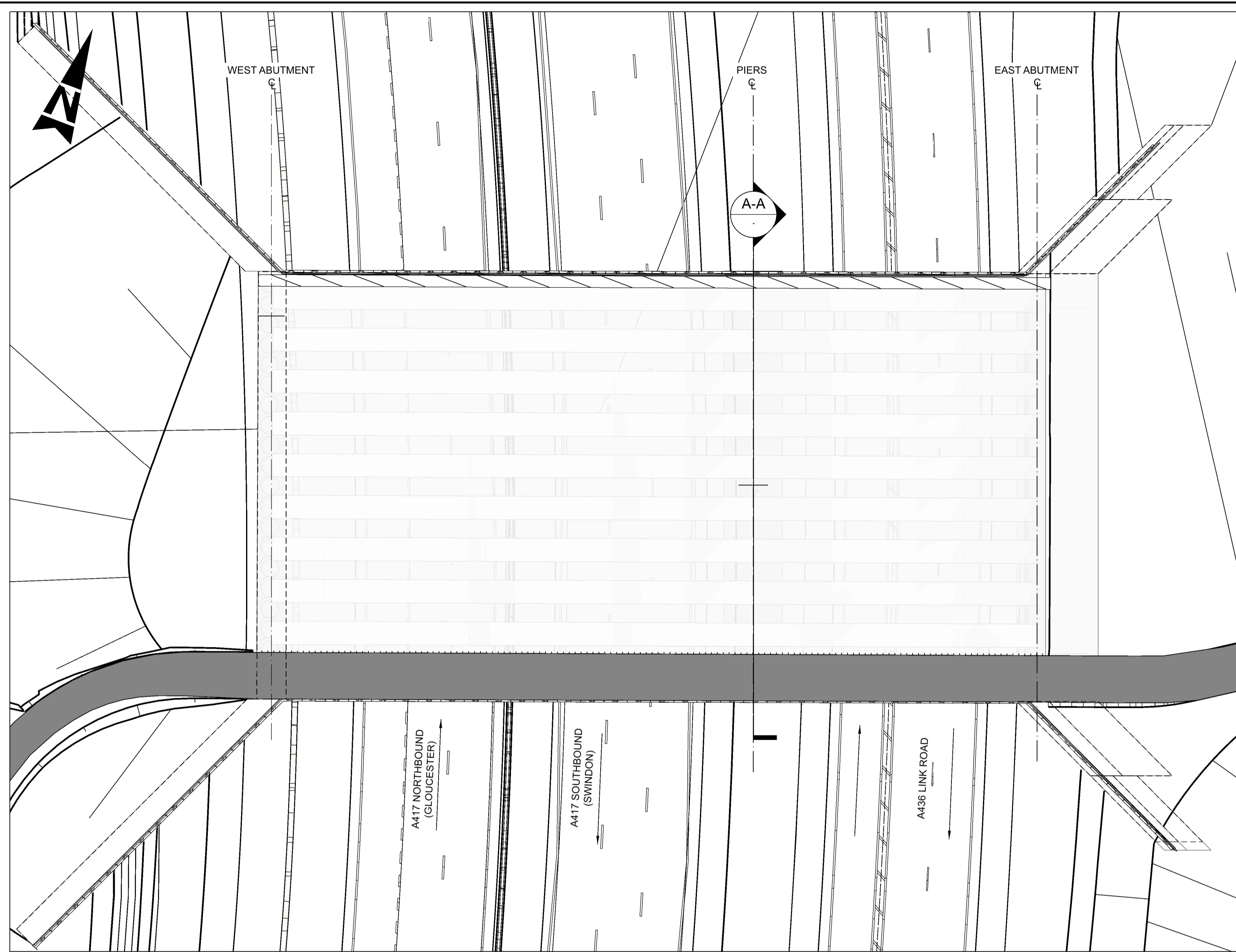

PLAN
SCALE 1:250

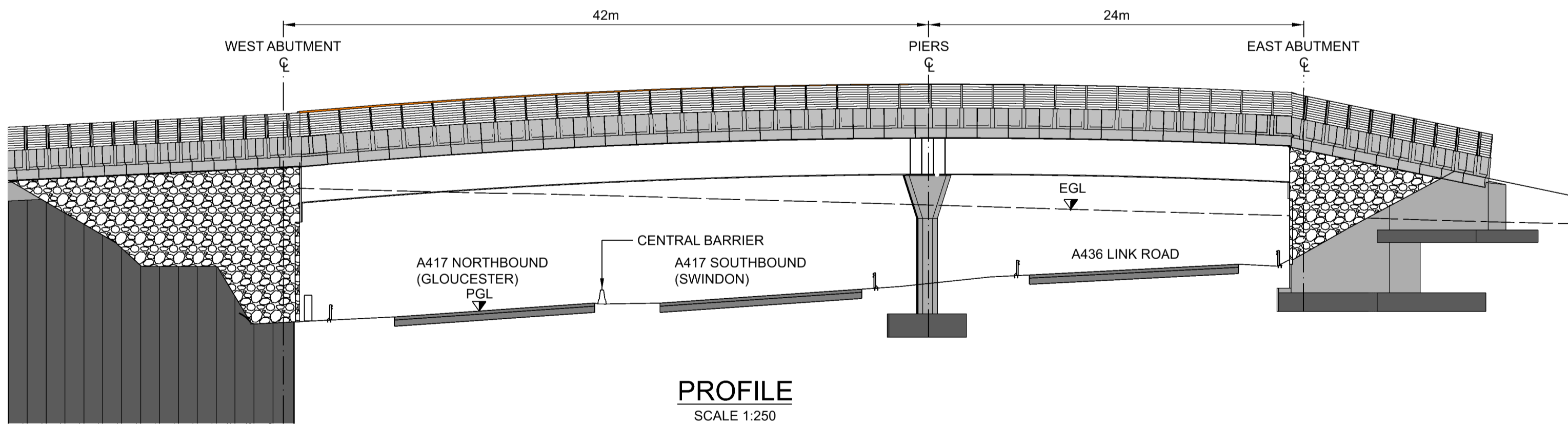

PROFILE
SCALE 1:250

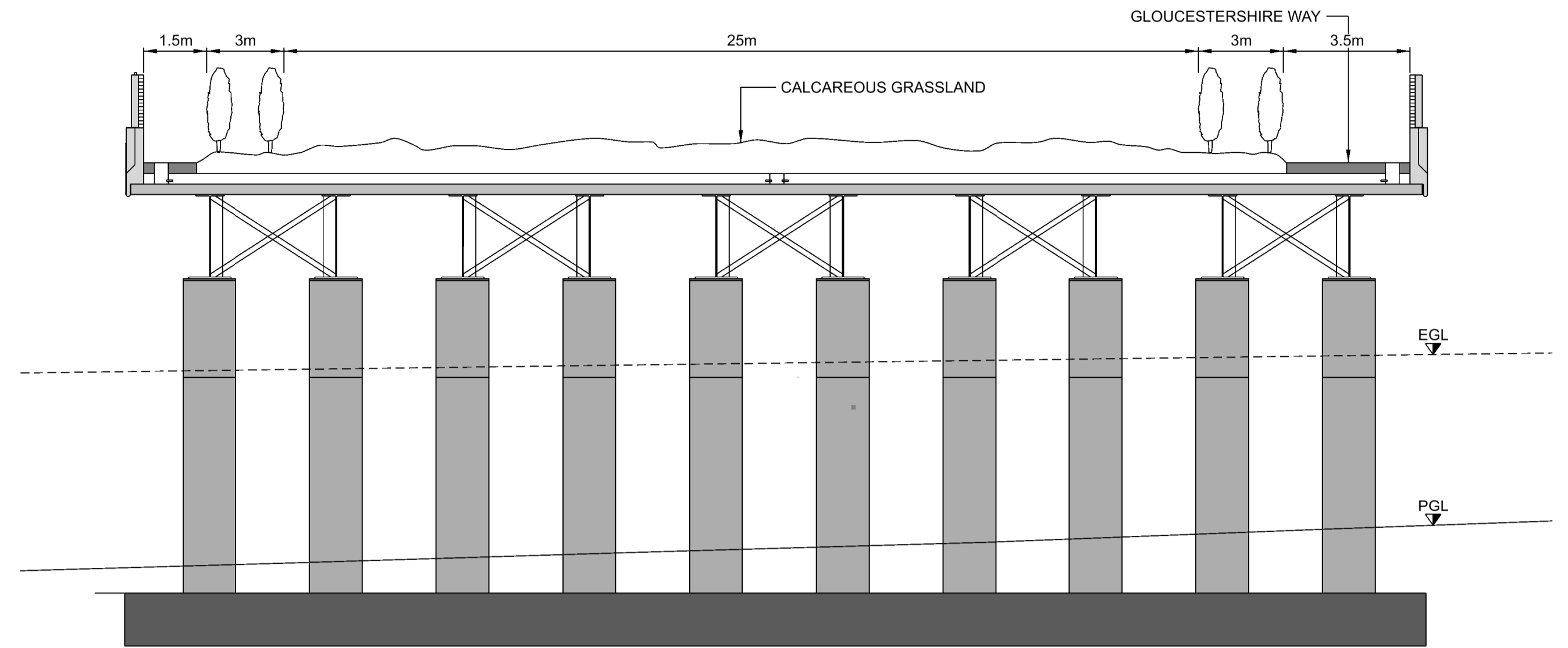

SECTION A-A
SCALE 1:125

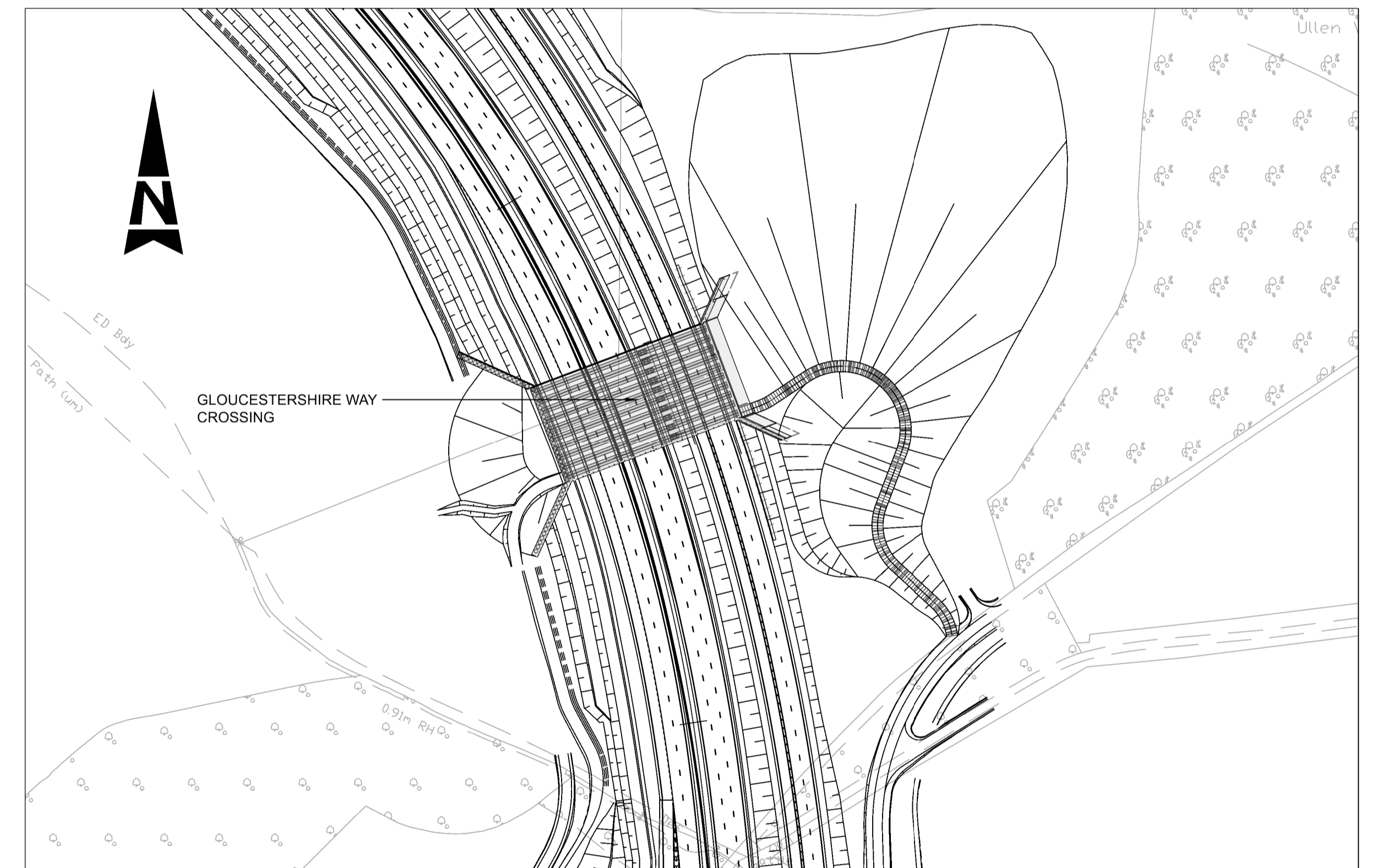

LOCATION PLAN
SCALE 1:250

This map is reproduced from Ordnance Survey material with the permission of Ordnance Survey on behalf of the controller of Her Majesty's Stationery Office. © Crown Copyright. Unauthorised reproduction infringes Crown copyright and may lead to prosecution or civil proceedings. CLIENT NAME: Highways England LICENCE NUMBER: 100030649 (2019)

- NOTES**
- THE DESIGN AND LOCATION OF THE STRUCTURE IS SHOWN HERE FOR ILLUSTRATIVE PURPOSES ONLY AND WILL BE SUBJECT TO DETAILED DESIGN DEVELOPMENT IN ACCORDANCE WITH THE PROVISIONS OF THE DEVELOPMENT CONSENT ORDER.
 - FOR ENVIRONMENTAL DETAILS REFER TO THE ENVIRONMENTAL MASTER PLAN AND ASSOCIATED DRAWINGS/DOCUMENTS.
 - FOR PUBLIC ACCESS DETAILS REFER TO THE RIGHTS OF WAY AND ACCESS PLANS
 - DETAILED DESIGN OF ALL STRUCTURES IS TO COMPLY WITH ALL RELEVANT PROVISIONS OF THE ENVIRONMENTAL MANAGEMENT PLAN, INCLUDING (WHERE APPLICABLE) COMMITMENT GPs, BD41, BD49, BD54, BD55, BD56, L5, L6, L7, L8, L9, L10, L11, L12, L21, L25
 - THE DETAILED DESIGN OF ALL STRUCTURES IS TO BE IN ACCORDANCE WITH THE DESIGN PRINCIPLES SET OUT IN THE DESIGN SUMMARY REPORT TO ENSURE THAT THE DESIGN, FORM AND APPEARANCE OF ALL BRIDGE STRUCTURES WILL RESPOND TO THE NATURAL AND BUILT CHARACTER OF THE COTSWOLDS AONB
 - EGL = EXISTING GROUND LEVEL, PGL = PROPOSED GROUND LEVEL

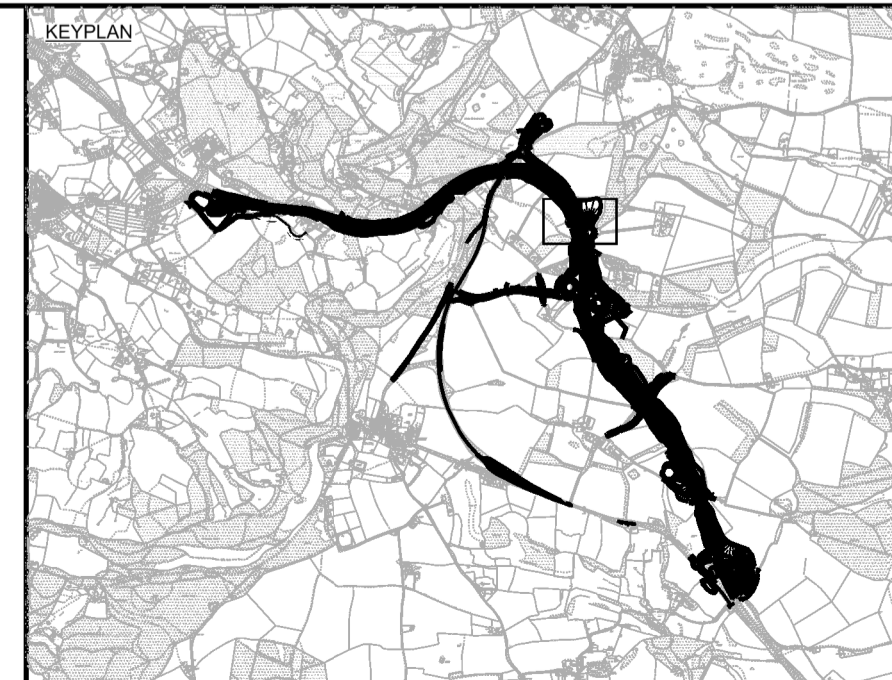

Rev.	Date	Description	By	Chk'd	App'd	Auth'd
C01	22/03/22	DEADLINE 6 ISSUE TO PINS	EM	DA	JP	JP

Suitability Drawing Status
A4 STAGE COMPLETED

ARUP

Client **highways england**

Project Title A417 MISSING LINK					
Drawing Title STRUCTURES ENGINEERING DRAWINGS AND SECTIONS GLOUCESTERSHIRE WAY CROSSING APPLICATION NUMBER TR010056					
Scale	By	Checked	Approved	Authorised	
As Shown	EM	DA	JP	JP	
Original Size	Date	Date	Date	Date	Date
A1	22/03/22	22/03/22	22/03/22	22/03/22	22/03/22
Drawing Number	Originator	Volume	Revision		
HE PIN	ARP	LSI	C01		
X_ML_40039_Z	-DR - ZL	-000001			
Location	Type	Role	Number		

DO NOT SCALE

100
0 10
Millimetres

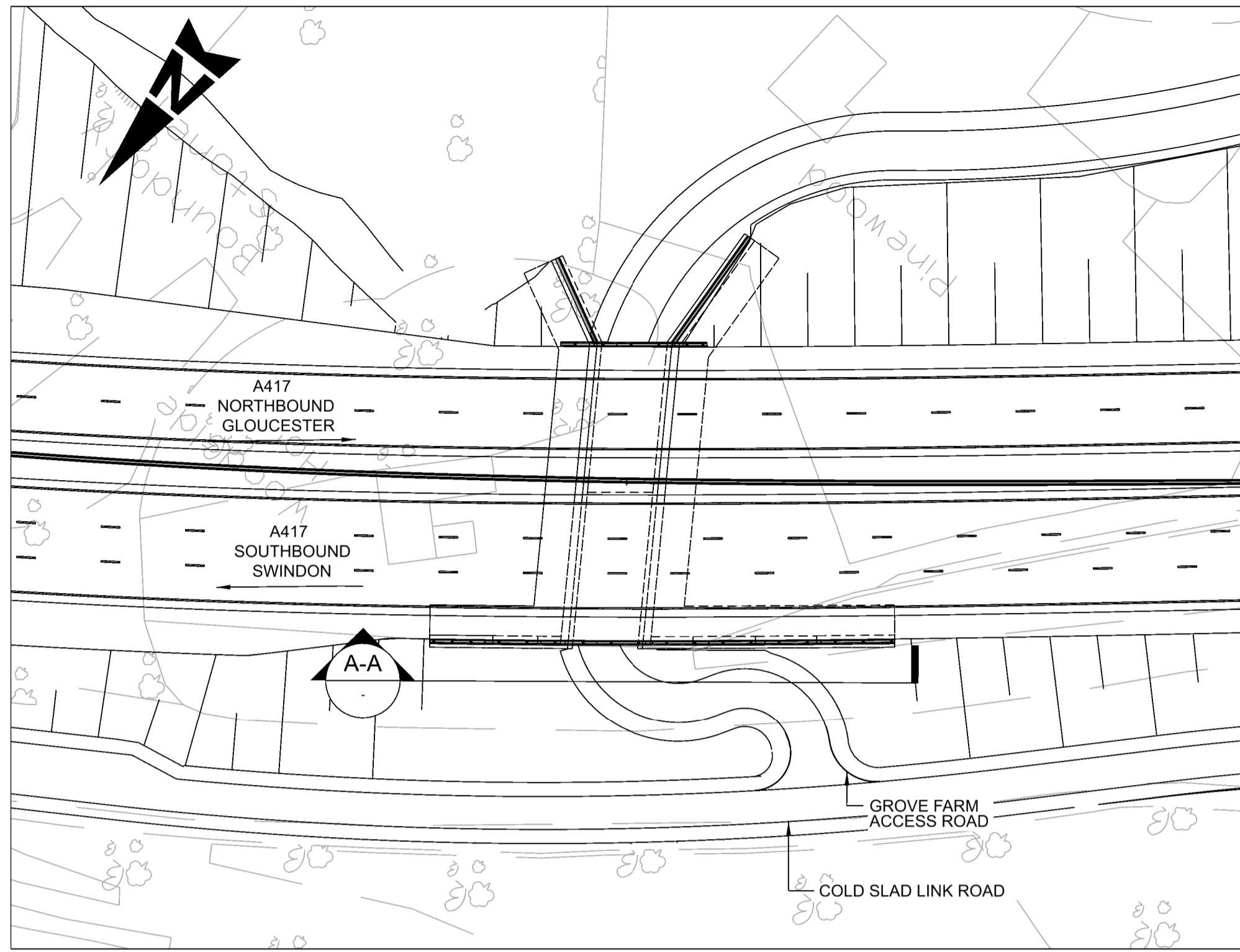

PLAN
SCALE 1:500

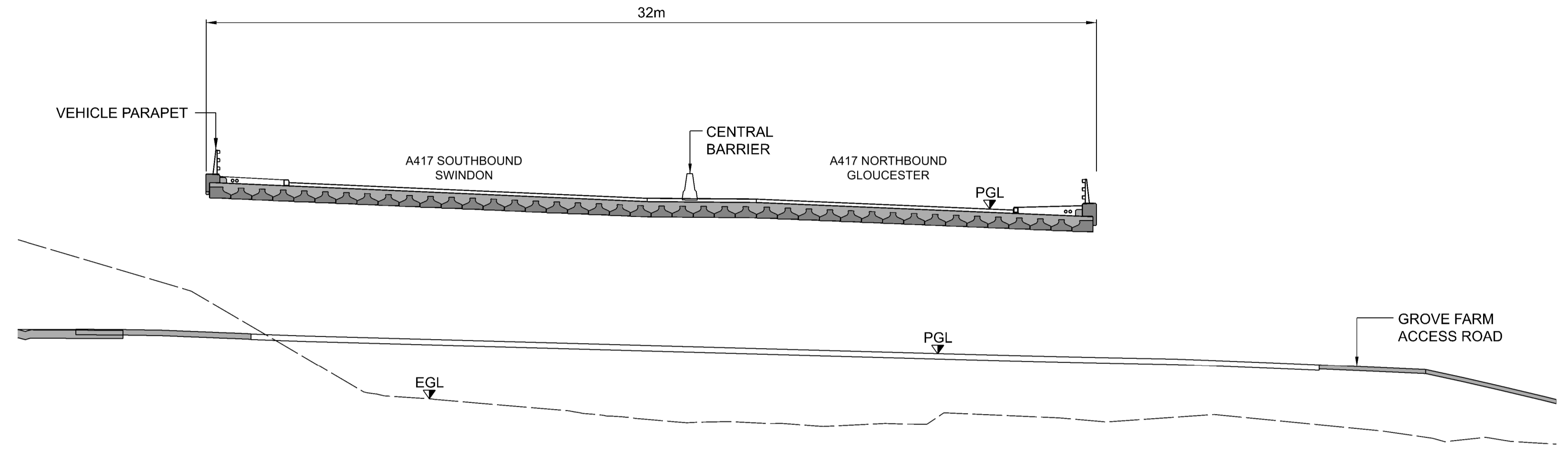

PROFILE
SCALE 1:125

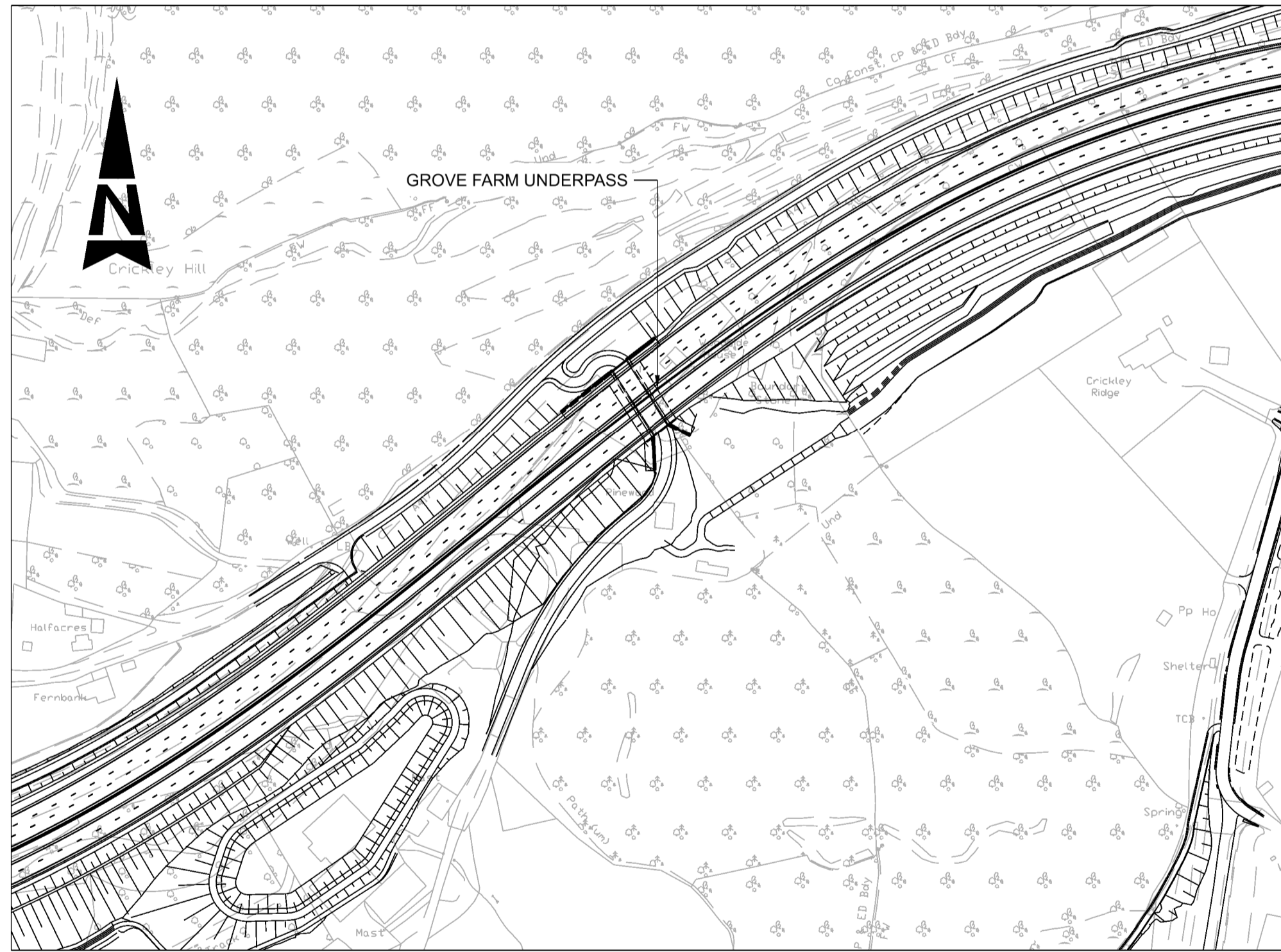

LOCATION PLAN
SCALE 1:2000

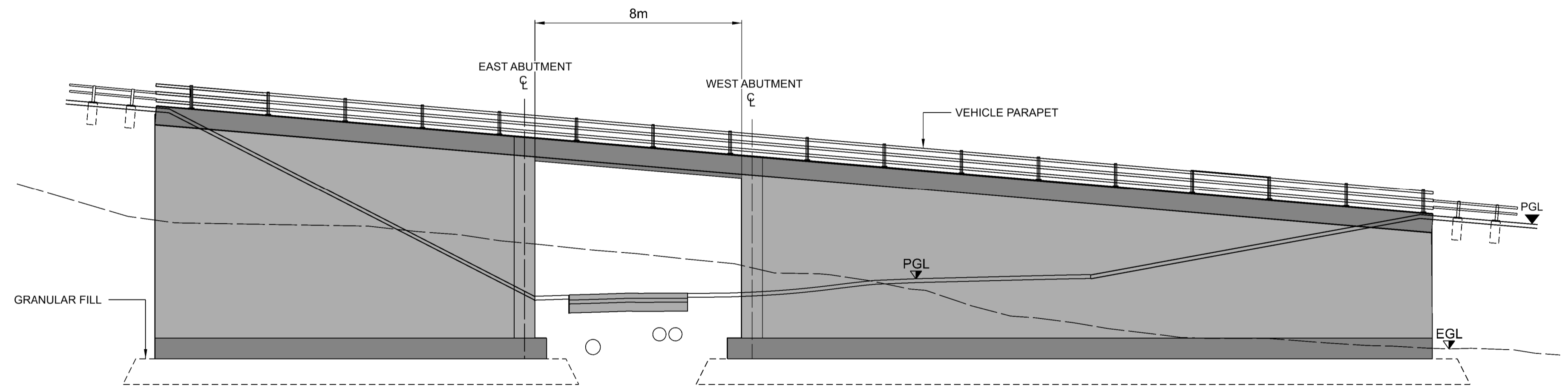

SECTION A-A
SCALE 1:125

- NOTES**
1. THE DESIGN AND LOCATION OF THE STRUCTURE IS SHOWN HERE FOR ILLUSTRATIVE PURPOSES ONLY AND WILL BE SUBJECT TO DETAILED DESIGN DEVELOPMENT IN ACCORDANCE WITH THE PROVISIONS OF THE DEVELOPMENT CONSENT ORDER.
 2. FOR ENVIRONMENTAL DETAILS REFER TO THE ENVIRONMENTAL MASTER PLAN AND ASSOCIATED DRAWINGS/DOCUMENTS.
 3. FOR PUBLIC ACCESS DETAILS REFER TO THE RIGHTS OF WAY AND ACCESS PLANS.
 4. DETAILED DESIGN OF ALL STRUCTURES IS TO COMPLY WITH ALL RELEVANT PROVISIONS OF THE ENVIRONMENTAL MANAGEMENT PLAN, INCLUDING (WHERE APPLICABLE) COMMITMENT GPR, BD41, BD49, BD54, BD55, SD56, LS, LR, L7, LR, L8, L10, L11, L12, L21, L25.
 5. THE DETAILED DESIGN OF ALL STRUCTURES IS TO BE IN ACCORDANCE WITH THE DESIGN PRINCIPLES SET OUT IN THE DESIGN SUMMARY REPORT TO ENSURE THAT THE DESIGN, FORM AND APPEARANCE OF ALL BRIDGE STRUCTURES WILL RESPOND TO THE NATURAL AND BUILT CHARACTER OF THE COTSWOLDS AONS.
 6. EGL = EXISTING GROUND LEVEL, PGL = PROPOSED GROUND LEVEL.



Rev.	Date	Description	By	Chk'd	App'd	Auth'd
C01	22/03/22	DEADLINE 6 ISSUE TO PINS	EM	DA	JP	JP

Suitability	A4	Drawing Status	STAGE COMPLETED
		Client	

Project Title						A417 MISSING LINK					
Drawing Title						STRUCTURES ENGINEERING DRAWINGS AND SECTIONS GROVE FARM UNDERPASS APPLICATION NUMBER TR010056					
Scale	As Shown	By	EM	Checked	DA	Approved	JP	Authorised	JP		
Original Size	A1	Date	22/03/22	Date	22/03/22	Date	22/03/22	Date	22/03/22		
Drawing Number	HE PIN	Originator	ARP	Volume	LSI	Revision		C01			
HE551505 - X_ML_40040_Z		-DR - ZL - 000001		Location		Type	Role	Number			

DO NOT SCALE

100
0 10
Millimetres

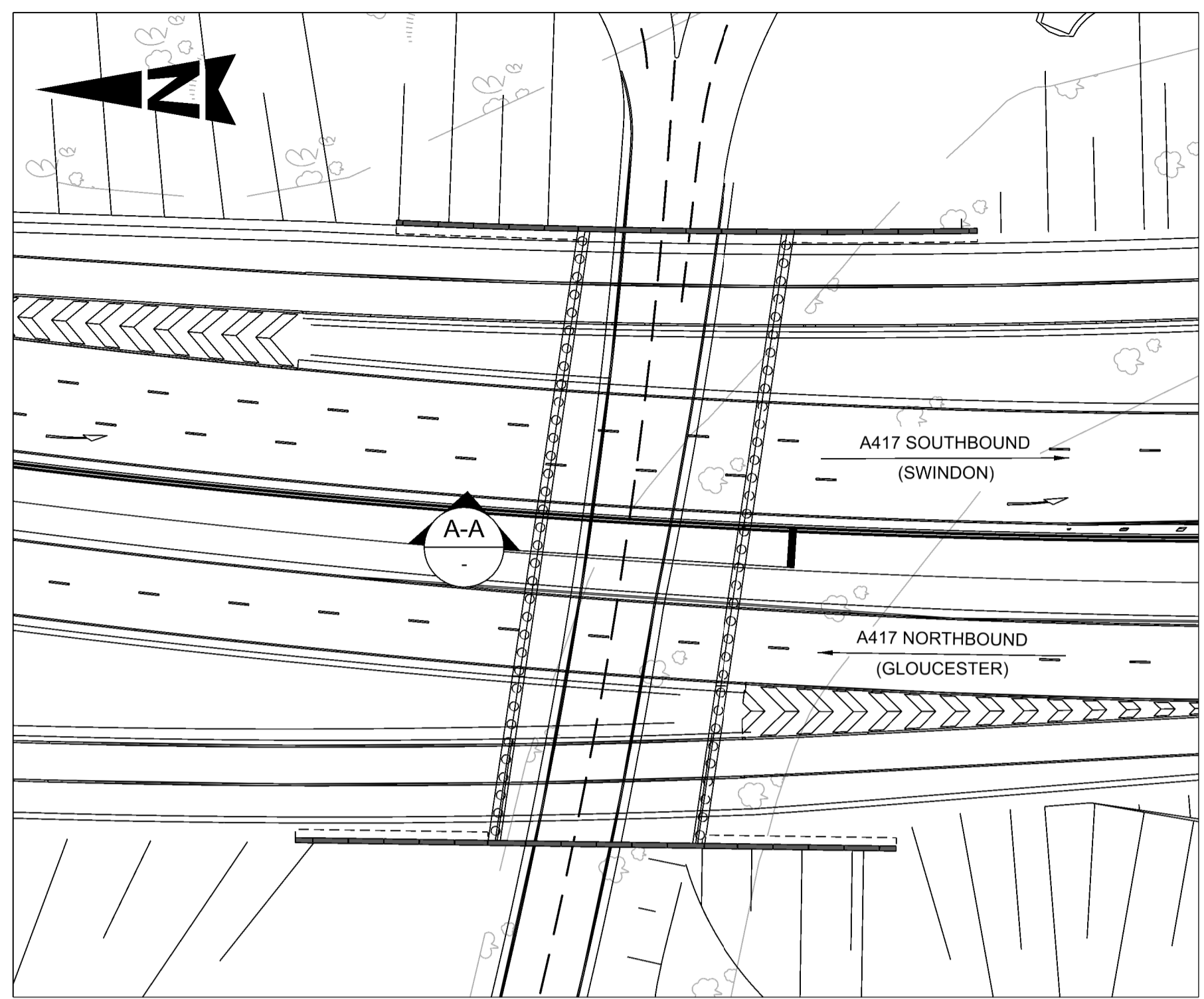

PLAN
SCALE 1:500

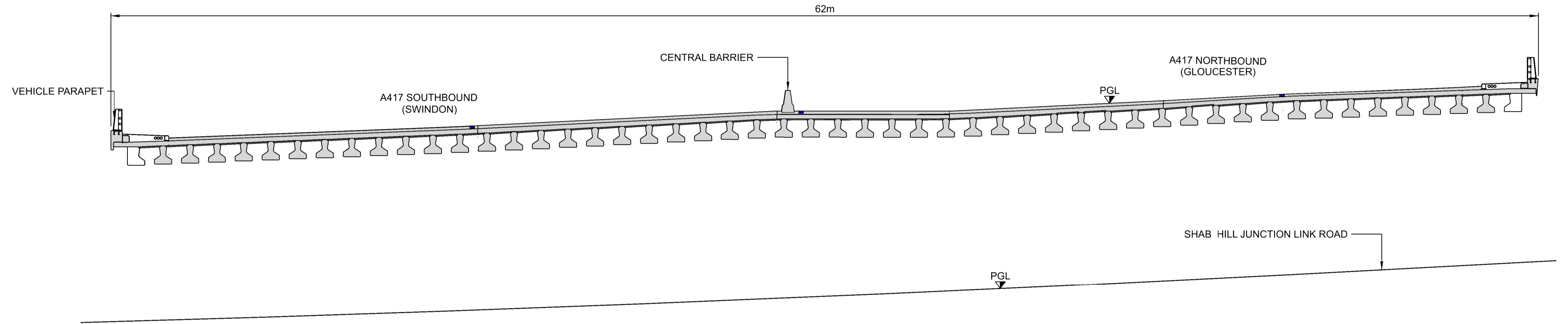

PROFILE
SCALE 1:500

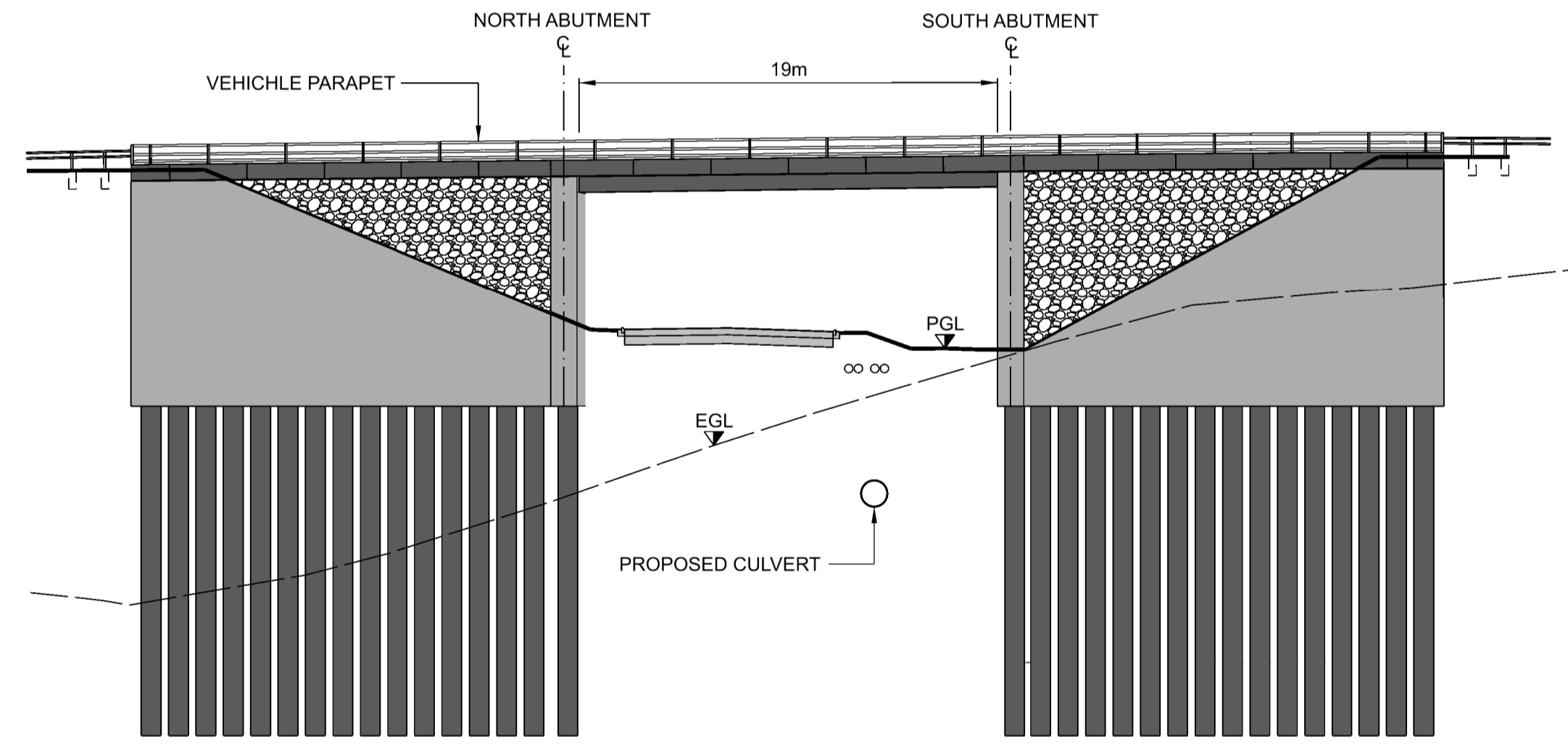

SECTION A-A
SCALE 1:250

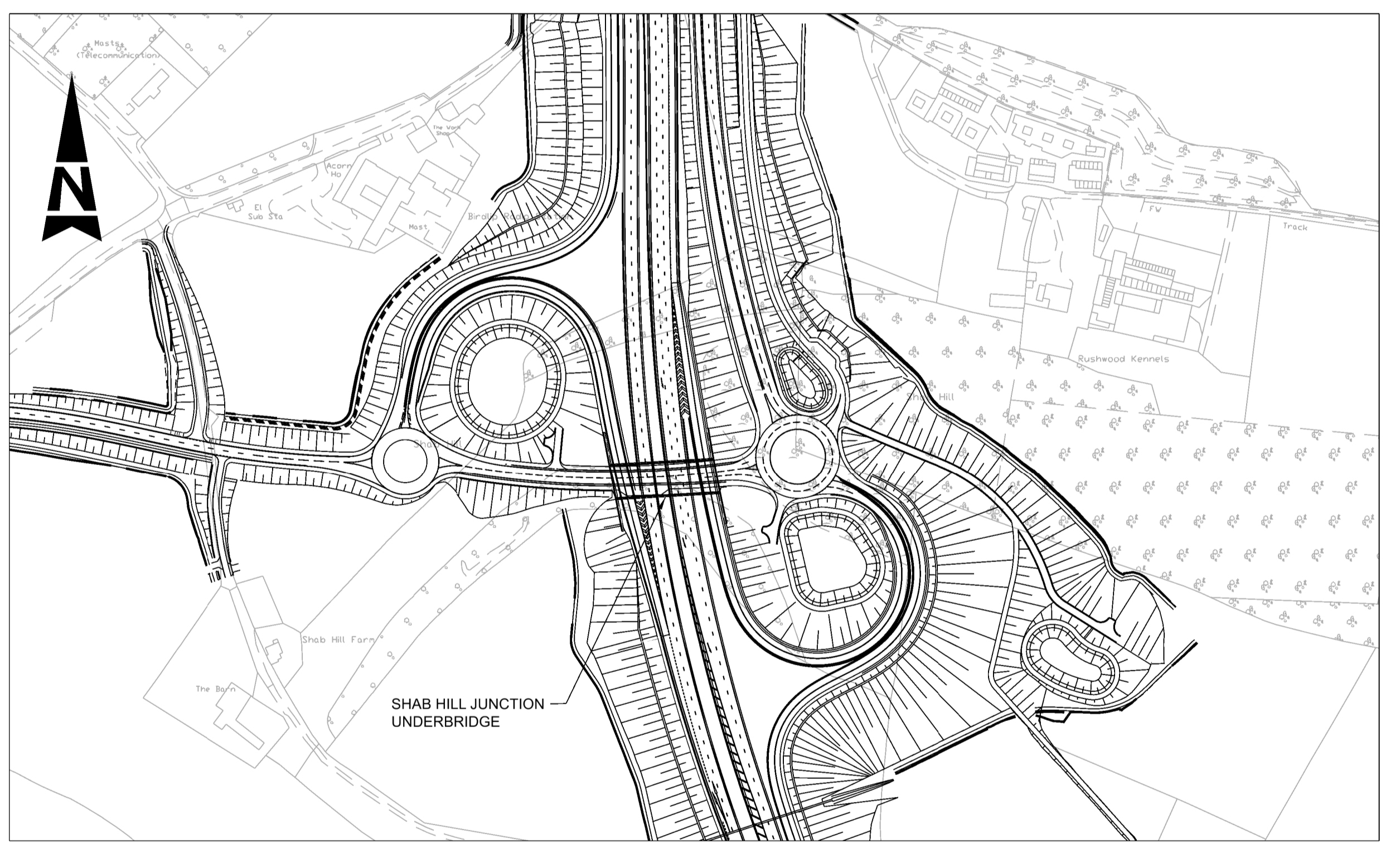

LOCATION PLAN
SCALE 1:250

- NOTES**
1. THE DESIGN AND LOCATION OF THE STRUCTURE IS SHOWN HERE FOR ILLUSTRATIVE PURPOSES ONLY AND WILL BE SUBJECT TO DETAILED DESIGN DEVELOPMENT IN ACCORDANCE WITH THE PROVISIONS OF THE DEVELOPMENT CONSENT ORDER.
 2. FOR ENVIRONMENTAL DETAILS REFER TO THE ENVIRONMENTAL MASTER PLAN AND ASSOCIATED DRAWINGS/DOCUMENTS.
 3. FOR PUBLIC ACCESS DETAILS REFER TO THE RIGHTS OF WAY AND ACCESS PLANS.
 4. DETAILED DESIGN OF ALL STRUCTURES IS TO COMPLY WITH ALL RELEVANT PROVISIONS OF THE ENVIRONMENTAL MANAGEMENT PLAN, INCLUDING (WHERE APPLICABLE) COMMITMENT G98, BD41, BD49, BD54, BD55, SD56, L5, L6, L7, L8, L9, L10, L11, L12, L21, L25.
 5. THE DETAILED DESIGN OF ALL STRUCTURES IS TO BE IN ACCORDANCE WITH THE DESIGN PRINCIPLES SET OUT IN THE DESIGN SUMMARY REPORT TO ENSURE THAT THE DESIGN, FORM AND APPEARANCE OF ALL BRIDGE STRUCTURES WILL RESPOND TO THE NATURAL AND BUILT CHARACTER OF THE COTSWOLDS AONS.
 6. EGL = EXISTING GROUND LEVEL, PGL = PROPOSED GROUND LEVEL.



Rev.	Date	Description	By	Chk'd	App'd	Auth'd
C01	22/03/22	DEADLINE 6 ISSUE TO PINS	EM	DA	JP	JP

Suitability: A4 | Drawing Status: STAGE COMPLETED

ARUP

highways
england

Project Title: A417 MISSING LINK					
Drawing Title: STRUCTURES ENGINEERING DRAWINGS AND SECTIONS SHAB HILL JUNCTION UNDERBRIDGE APPLICATION NUMBER TR010056					
Scale: As Shown	By: EM	Checked: DA	Approved: JP	Authorised: JP	
Original Size: A1	Date: 22/03/22	Date: 22/03/22	Date: 22/03/22	Date: 22/03/22	Date: 22/03/22
Drawing Number: HE551505 - X_ML_39184_Z	Originator: ARP	Volume: LSI	Revision: C01		
Location: -DR - ZL - 000001	Type: -DR	Role: -ZL	Number: 000001		

DO NOT SCALE

100
0 10
Millimetres

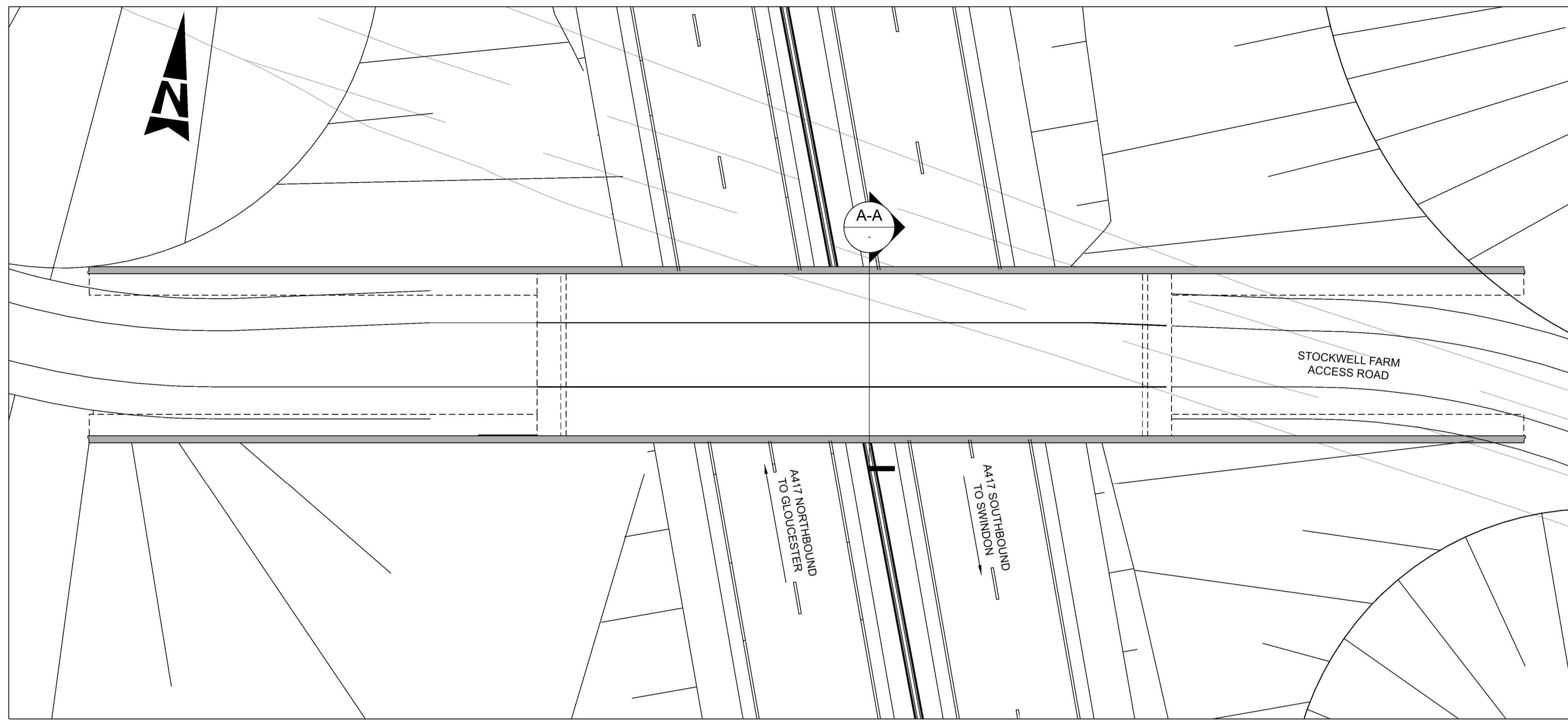

PLAN
SCALE 1:200

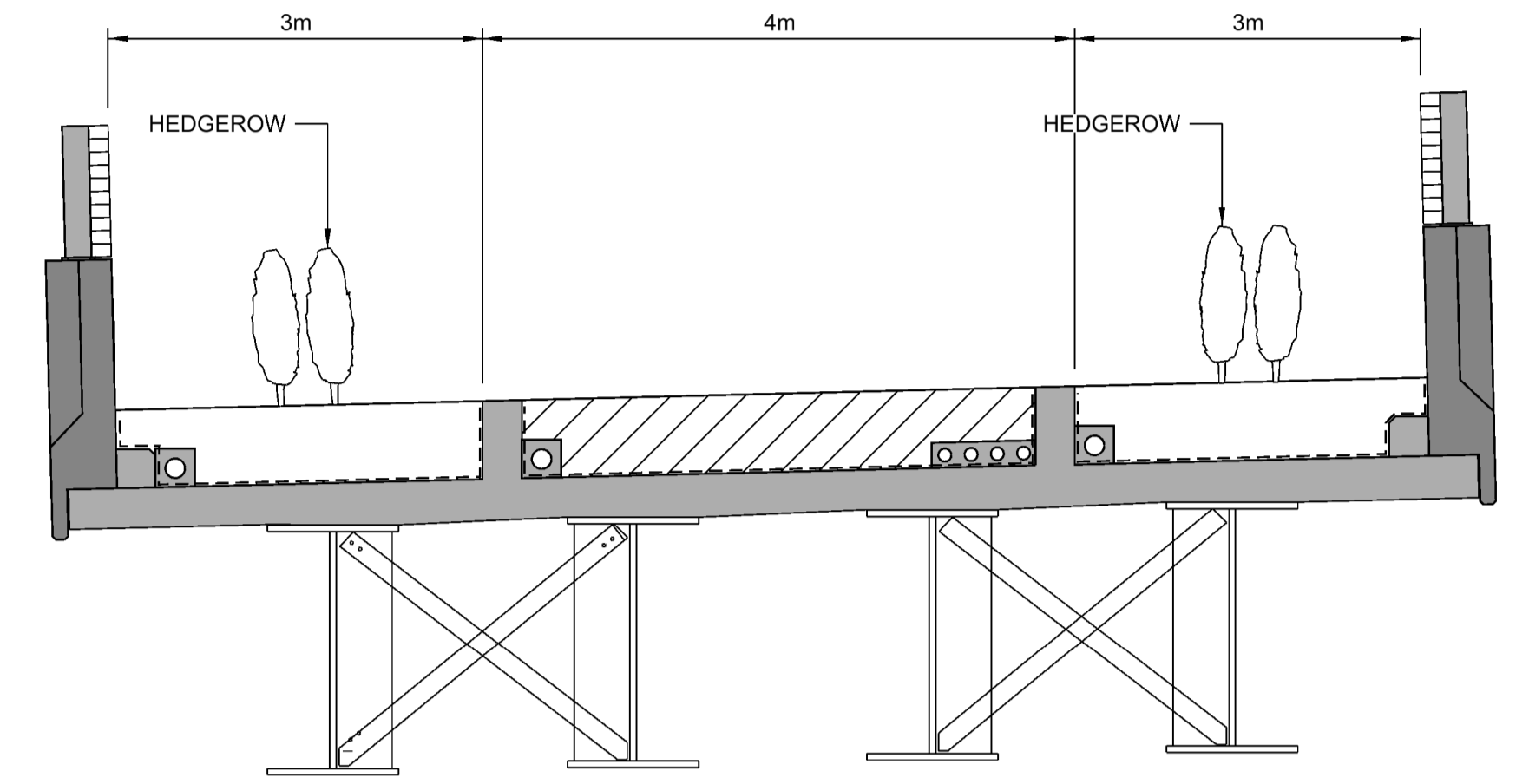

SECTION A-A
SCALE 1:50

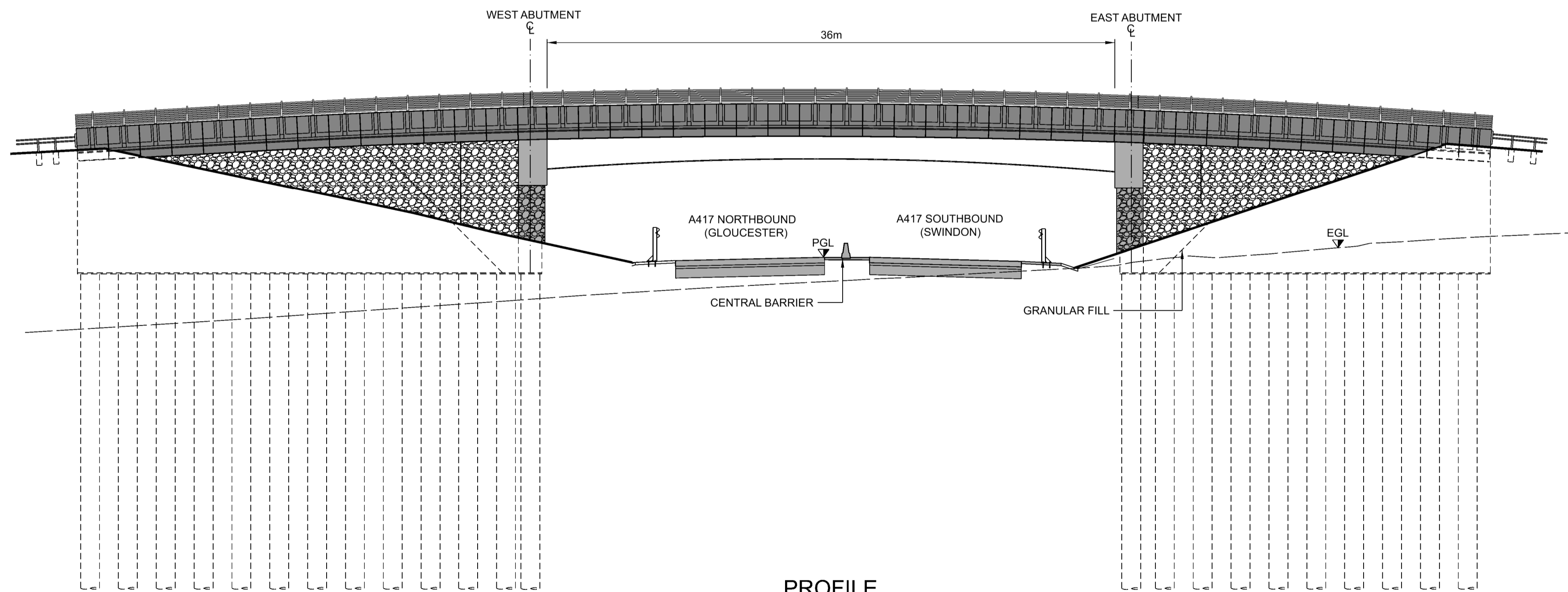

PROFILE
SCALE 1:200

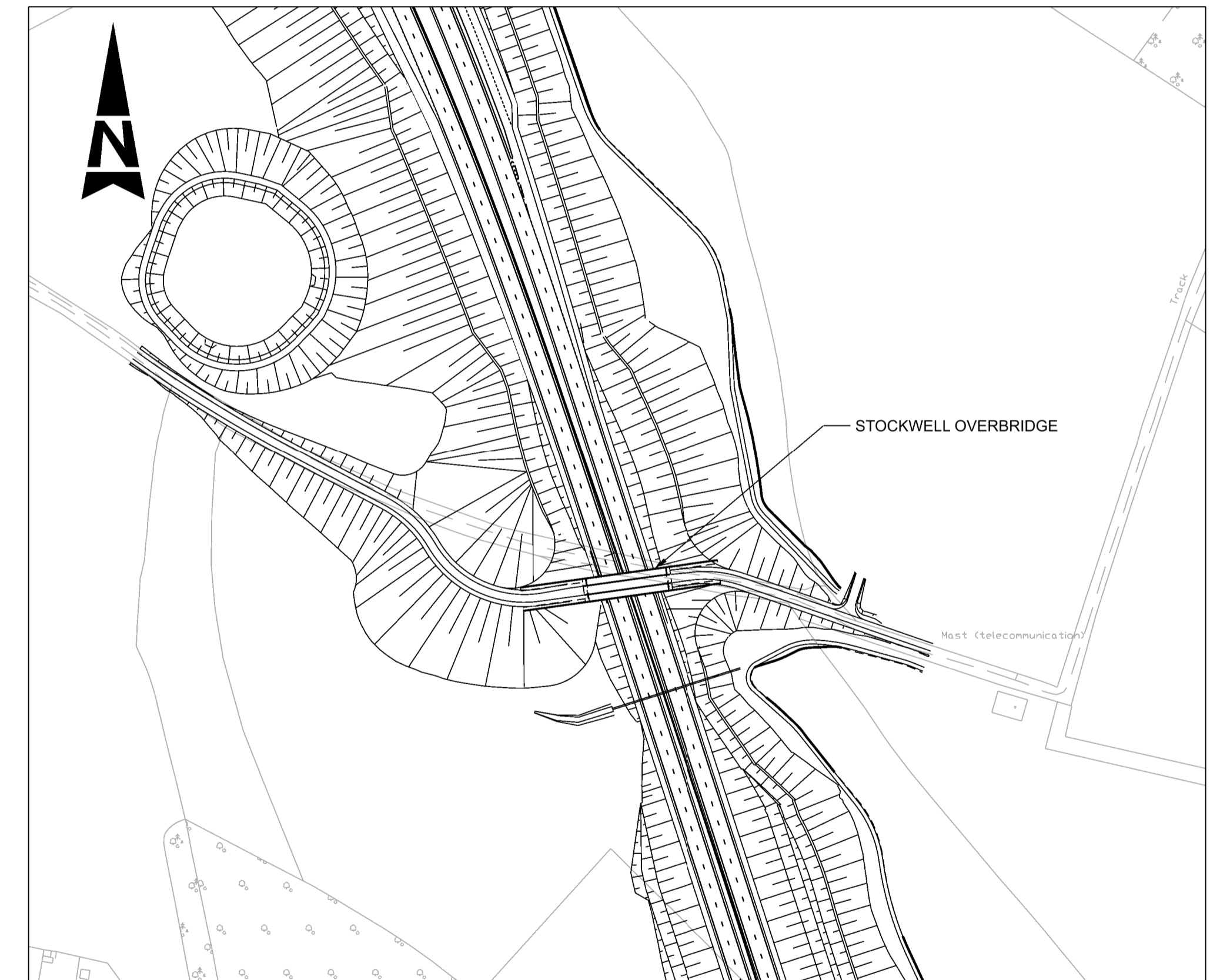

LOCATION PLAN
SCALE 1:2000

- NOTES**
- THE DESIGN AND LOCATION OF THE STRUCTURE IS SHOWN HERE FOR ILLUSTRATIVE PURPOSES ONLY AND WILL BE SUBJECT TO DETAILED DESIGN DEVELOPMENT IN ACCORDANCE WITH THE PROVISIONS OF THE DEVELOPMENT CONSENT ORDER.
 - FOR ENVIRONMENTAL DETAILS REFER TO THE ENVIRONMENTAL MASTER PLAN AND ASSOCIATED DRAWINGS/DOCUMENTS.
 - FOR PUBLIC ACCESS DETAILS REFER TO THE RIGHTS OF WAY AND ACCESS PLANS.
 - DETAILED DESIGN OF ALL STRUCTURES IS TO COMPLY WITH ALL RELEVANT PROVISIONS OF THE ENVIRONMENTAL MANAGEMENT PLAN, INCLUDING (WHERE APPLICABLE) COMMITMENT G98, BD41, BD49, BD54, BD55, SD56, L5, L6, L7, L8, L9, L10, L11, L12, L21, L25.
 - THE DETAILED DESIGN OF ALL STRUCTURES IS TO BE IN ACCORDANCE WITH THE DESIGN PRINCIPLES SET OUT IN THE DESIGN SUMMARY REPORT TO ENSURE THAT THE DESIGN, FORM AND APPEARANCE OF ALL BRIDGE STRUCTURES WILL RESPOND TO THE NATURAL AND BUILT CHARACTER OF THE COTSWOLDS AONS.
 - EGL = EXISTING GROUND LEVEL, PGL = PROPOSED GROUND LEVEL.



Rev.	Date	Description	By	Chk'd	App'd	Auth'd
C01	22/03/22	DEADLINE 6 ISSUE TO PINS	EM	DA	JP	JP

Suitability	Drawing Status
A4	STAGE COMPLETED
ARUP	
highways england	

Project Title						A417 MISSING LINK					
Drawing Title						STRUCTURES ENGINEERING DRAWINGS AND SECTIONS STOCKWELL OVERBRIDGE APPLICATION NUMBER TR010056					
Scale	By	Checked	Approved	Authorised		As Shown	EM	DA	JP	JP	
Original Size	Date	Date	Date	Date		A1	22/03/22	22/03/22	22/03/22		
Drawing Number	HE PIN	Originator	Volume	Revision		HE551505 - ARP	- LSI				C01
	X_ML_39187_Z	-DR - ZL	-000001								
	Location	Type	Role	Number							